

66235

# Location of Wastewater Connection



Public Works Maintenance  
1820 Roosevelt Blvd.  
Eugene, Oregon 97402  
(541) 682-4800

### Property Information

Address 3544 Sisters View  
Map and Tax Lot \_\_\_\_\_ Owner Jake Burnham  
Building Type:  SFD  Duplex  Multi-Family  Commercial  Industrial

### Permit Information

Permit No. 18-02434-01 Date of Issue 4-3-18  
Contractor/Plumber Jake Burnham Pipe Material Sch40/3034 Pipe Diameter 4"  
 Right of Way Cut Permit Required  System Development Charge  
Installation Date 10-17-18 Inspected By LaCasse

*Permission granted to attach private sewer connection to public sewer in conformance to City standards and specifications.*

### Public Wastewater Information

Index Page No. 98 Segment No. 9435 Inspected By \_\_\_\_\_  
Upstream Downstream Contract No. \_\_\_\_\_

TWO WORKING DAYS BEFORE YOU DIG, CALL UTILITY ONE-CALL SERVICE AT 1-800-332-2344

Sisters View Ave

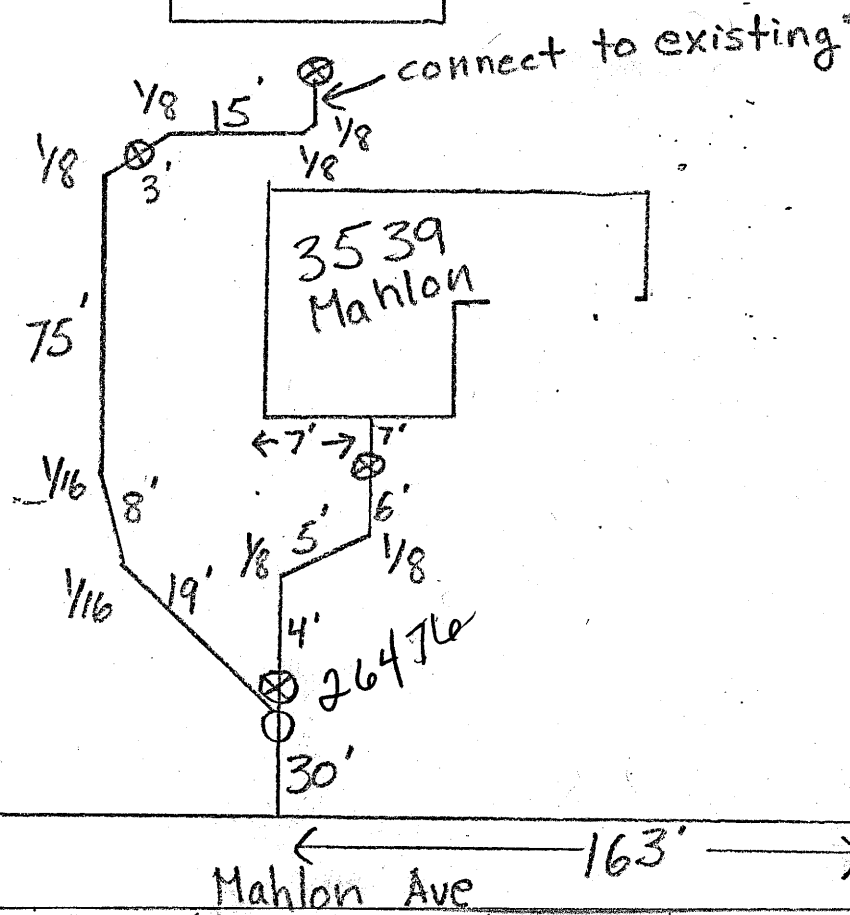
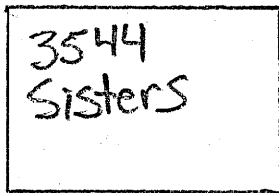
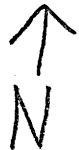

WWMH# 13086

WWMH# 9435

Mahlon Ave

163'